

CENTRAL MACHINERY®

WOOD BANDSAW 14" W/DUST COLLECTOR

Models 32206/32208

OPERATING INFORMATION

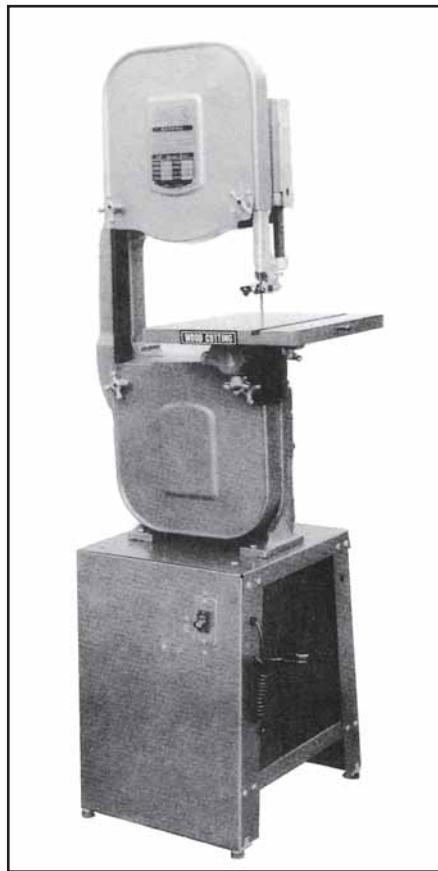

3491 Mission Oaks Blvd., Camarillo, CA 93011
Visit our website at <http://www.harborfreight.com>

Copyright© 2001 by Harbor Freight Tools®. All rights reserved. No portion of this manual or any artwork contained herein may be reproduced in any shape or form without the express written consent of Harbor Freight Tools.

For technical questions or replacement parts, please call 1-800-444-3353.

SPECIFICATIONS

ITEM	DESCRIPTION
Net Weight	160 Lbs.
Speeds	3000 RPM (Model 32206) / 600, 1140, 1670, 2670 RPM (Model 32208)
Motor	Motor: 1 HP / Single Phase
Electrical Requirements	110V / 9 Amps
Cutting Capacity	6"
Blade Thickness Ranges	1/8" to 3/4"
Table Dimensions	Approx. 14" x 14"
Table Adjustments	Tilts 45° to Right / 15° to Left
Dust Collector Accessory	Dust Chute Attachment Only (Dust Bag Not Provided)

SAVE THIS MANUAL

You will need the manual for the safety warnings and precautions, assembly instructions, operating and maintenance procedures, parts list and diagrams. Keep your invoice with this manual. Write the invoice number on the inside of the front cover. Keep the manual and invoice in a safe and dry place for future reference.

GENERAL SAFETY WARNINGS AND PRECAUTIONS

1. **KEEP WORK AREA CLEAN AND DRY.** Cluttered, damp or wet work areas invite injuries.
2. **KEEP CHILDREN AWAY FROM WORK AREA.** Do not allow children to handle this product.
3. **STORE IDLE EQUIPMENT.** When not in use, tools and equipment should be stored in a dry location to inhibit rust. Always lock up tools and equipment and keep out of reach of children.
4. **DO NOT USE THIS PRODUCT IF UNDER THE INFLUENCE OF ALCOHOL OR DRUGS.** Read warning labels on prescriptions to determine if your judgment or reflexes are impaired while taking drugs. If there is any doubt, do not attempt to use this product.

5. **USE EYE, HEARING, AND BREATHING PROTECTION.** Wear ANSI approved safety impact eye glasses, ANSI approved hearing protection, and ANSI approved dust mask or respirator when using this product. ANSI approved safety impact eye glasses, hearing protection, and dust masks and respirators are available from Harbor Freight Tools.
6. **DRESS SAFELY.** Non-skid footwear or safety shoes should be used when working with this product. Do not wear loose clothing or jewelry as they can become caught in moving parts. Wear a protective hair covering to prevent long hair from becoming caught in moving parts. If wearing a long-sleeve shirt, roll sleeves up above elbows.
7. **INDUSTRIAL APPLICATIONS MUST FOLLOW OSHA REQUIREMENTS.**
8. **DO NOT OVERREACH.** Keep proper footing and balance at all times to prevent tripping, falling, back injury, etcetera.
9. **STAY ALERT.** Watch what you are doing at all times. Use common sense. Do not use this product when you are tired or distracted from the job at hand.
10. **CHECK FOR DAMAGED PARTS.** Before using this product, carefully check that it will operate properly and perform its intended function. Check for damaged parts and any other conditions that may affect the operation of this product. Replace or repair damaged or worn parts immediately.
11. **REPLACEMENT PARTS AND ACCESSORIES.** When servicing, use only identical replacement parts. Only use accessories intended for use with this product. Approved accessories are available from Harbor Freight Tools.
12. **MAINTAIN THIS PRODUCT WITH CARE.** Keep this tool clean and dry, and keep saw blades clean and sharp for better and safer performance.
13. **MAINTENANCE:** For your safety, service and maintenance should be performed regularly by a qualified technician.
14. **USE THE RIGHT PRODUCT FOR THE RIGHT JOB.** There are certain applications for which this product was designed. Do not use small equipment, tools or attachments to do the work of larger industrial equipment, tools or attachments. Do not use this product for a purpose for which it was not intended.

SPECIFIC PRODUCT WARNINGS AND PRECAUTIONS

1. **GROUND THIS PRODUCT.** The electrical power cord for this product is equipped with a grounded 3-prong plug. Never remove the grounding prong or modify the plug in any way. Do not use adapter plugs with this product. When in use, make sure this product is always plugged into a grounded 3-hole electrical receptacle with an appropriate breaker switch inline.

2. **MAKE SURE THE POWER SWITCH IS IN THE “OFF” POSITION BEFORE PLUGGING IN THE POWER CORD.**
3. **DO NOT ABUSE THE POWER CORD.** Do not use the cord to pull the 3-prong plug from a power outlet. Keep cord away from heat, oil, sharp edges, and moving parts. Replace damaged cord immediately. Route the power cord safely. Protect it from being damaged by other equipment in the shop. Do not route the cord where it can be walked on or tripped over.
4. **IF YOU USE AN EXTENSION CORD, MAKE SURE TO USE ONLY UL APPROVED CORDS HAVING THE CORRECT GAUGE AND LENGTH. (SEE FIGURE A.)**

Nameplate Amperes	Extension Cord Length					
	25'	50'	75'	100'	150'	200'
0 - 5	16	16	16	14	12	12
5.1 - 8	16	16	14	12	10	—
8.1 - 12	14	14	12	10	—	—
12.1 - 15	12	12	10	10	—	—
15.1 - 20	10	10	10	—	—	—

FIGURE A

5. **MAINTAIN A SAFE WORK ENVIRONMENT.** Do not use this product in or near damp or wet areas. Do not expose this product to rain. Keep work area well lit. Make sure there is adequate surrounding work space. Use this product in a well ventilated area. Do not operate this product in the presence of flammable liquids, gases, or dust. To avoid accidental electric shock, do not let your body come in contact with grounded surfaces such as pipes, radiators, ranges and refrigerators.
6. **DO NOT FORCE THE EQUIPMENT.** This Bandsaw will do the work better and safer at the speed and capacity for which it was designed.
7. **KEEP ALL GUARDS IN PLACE AND IN WORKING ORDER.**
8. **REMOVE ALL ADJUSTING WRENCHES FROM THE BANDSAW BEFORE TURNING IT ON.**
9. **MAKE SURE THAT WHEN INSTALLING THE SAW BLADE THE SAW TEETH POINT DOWNWARD AND TOWARD THE TABLE (36) OF THE BANDSAW.**

10. **AVOID UNINTENTIONAL STARTING.** Make sure you are prepared to begin work before turning the START switch on.
11. **DO NOT USE THIS TOOL FOR CUTTING METALS OR BRITTLE MATERIALS.** Do not cut dangerous materials, such as asbestos which can cause harmful dust or vapors.
12. **CAUTION:** Some woods contain preservatives such as copper chromium arsenate (CCA) which can be toxic. When cutting these materials extra care should be taken to avoid inhalation and minimize skin contact.
13. **BEFORE USING THE BANDSAW, MAKE SURE THE SAW BLADE IS PROPERLY MOUNTED.** Make sure the saw blade is balanced, its tension and tracking are properly adjusted, its teeth point downward, and it is not bent or cracked.
14. **ALLOW THE SAW BLADE TO SPIN UP TO FULL SPEED BEFORE FEEDING WOOD INTO IT.** When turning it off, allow the saw blade to spin down and stop on its own. Do not press against the saw blade to stop it.
15. **DO NOT FORCE THE MATERIAL INTO THE SAW BLADE WHEN CUTTING.** Apply moderate pressure, allowing the saw blade to cut without being forced.
16. **NEVER ATTEMPT TO REMOVE MATERIAL STUCK IN THE MOVING PARTS OF THE BANDSAW WHILE THE SAW IS PLUGGED IN AND RUNNING.**
17. **THE SAW BLADE WILL BECOME HOT WHILE CUTTING.** Allow the saw blade to completely cool before touching.
18. **WHENEVER POSSIBLE, USE CLAMPS OR OTHER SAFE, PRACTICAL WAYS TO HOLD AND SUPPORT THE WORKPIECE.** Do not attempt to saw material that does not have a flat surface, unless a suitable support is used.
19. **ADJUST THE BLADE GUIDE (29)** about 1/8" (3.2mm) above the material being cut.
20. **TURN OFF THE BANDSAW IF THE MATERIAL IS TO BE BACKED OUT OF AN UNCOMPLETED CUT.**
21. **MAKE "RELIEF" CUTS BEFORE CUTTING LONG CURVES.**
22. **ALWAYS KEEP HANDS AND FINGERS AWAY FROM BLADE.**
23. **ALWAYS DISCONNECT THE BANDSAW FROM ITS ELECTRICAL SUPPLY SOURCE BEFORE PERFORMING ANY SERVICES OR MAINTENANCE** such as leaving the work area, moving the tool from one location to another, changing the saw blade, cleaning sawdust from the unit, etcetera.

UNPACKING

When unpacking, check to make sure all parts shown on the Parts List (pages 20, 22, 23, 24, 25 and 26) are included. If any parts are missing or broken, please call Harbor Freight Tools at the number shown on the cover of this manual as soon as possible.

OPERATING INSTRUCTIONS

NOTE: For ***additional references to the parts listed below, refer to pages 20, through 28 of this manual.***

To Assemble The Stand:

1. ***NOTE:*** During the following 7 steps, ***loosely finger tighten*** all Bolts and Nuts.
2. Set the Front and Back Stands (2A, 3A) upright with the two square holes nearest the edge at the top. Attach the Face Plate (1A) over the top of the Front and Back Stands (2A, 3A), using the Carriage Bolts, Washers, and Nuts (I). **(See Figure B and Hardware Diagram.)**
3. Attach the two Support Plates (7A) inside each side of the Front and Back Stands (2A, 3A), using the Carriage Bolts, Washers, and Nuts (I). **(See Figure C and Hardware Diagram.)**
4. Attach the Motor Plate Bracket (9A) to the front of the Face Plate (1A) with the raised section of it towards the middle, using the Carriage Bolts, Washers, and Nuts (I). (Note the location of the Switch Cover (13A) in relation to the mounting position.) **(See Figure D and Hardware Diagram.)**
5. Attach the Stiffening Plate (8A) to the underside and toward the rear of the Face Plate (1A), using the Carriage Bolts, Washers, and Nuts (I). **(See Figure D, Assembly Diagram A, and Hardware Diagram.)**

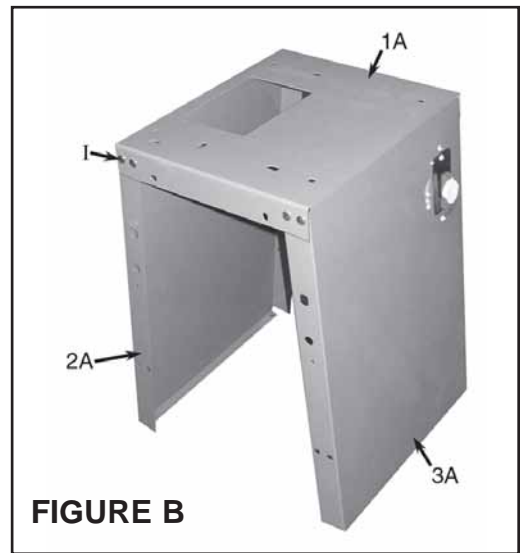

FIGURE B

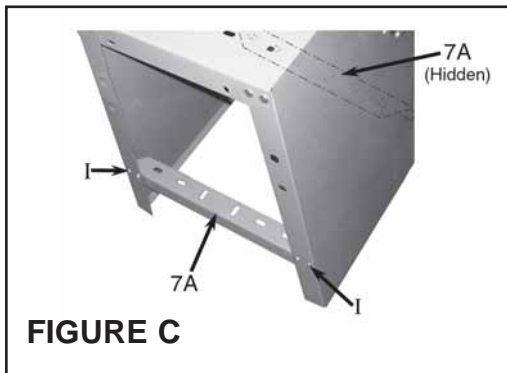

FIGURE C

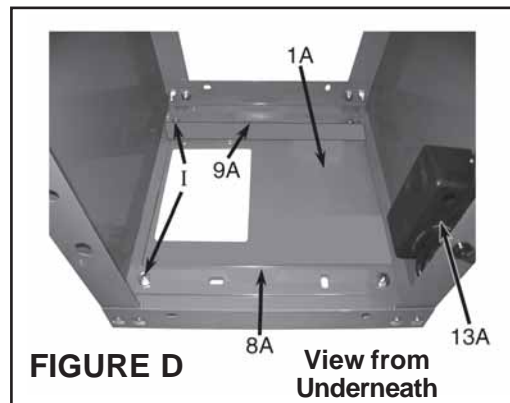
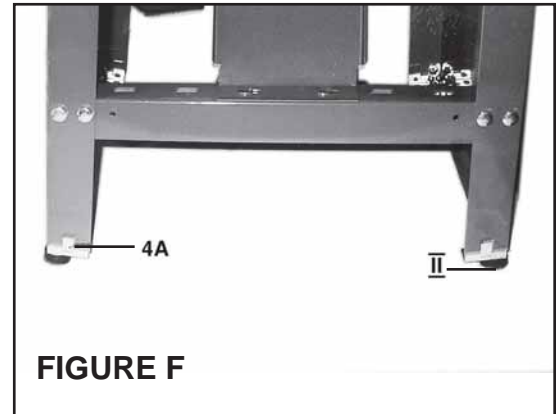
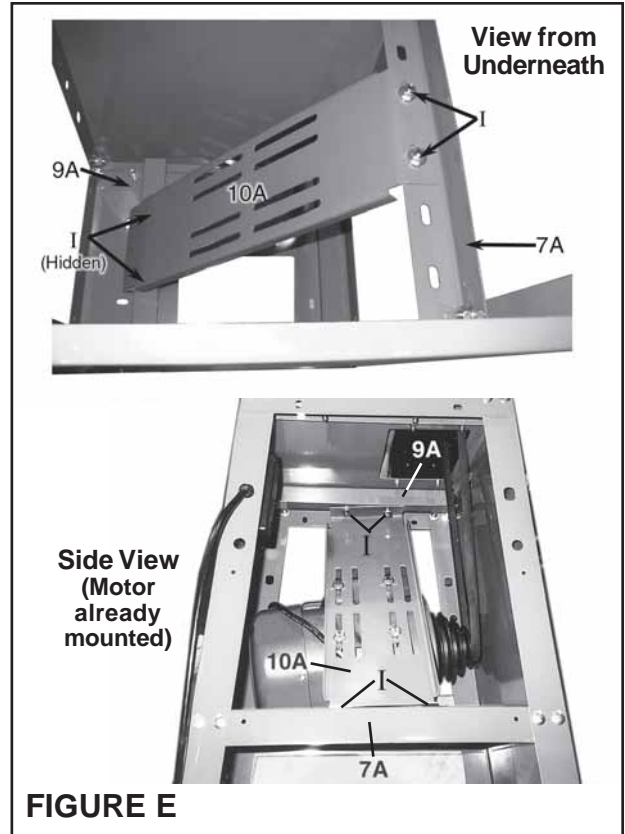

FIGURE D

**View from
Underneath**

6. Attach one end of the Motor Plate (10A) to the Motor Plate Bracket (9A), using the Hex Bolts, Washers, Spring Washers, and Nuts (I). **(See Figure E and Hardware Diagram.)**
7. Attach the other end of the Motor Plate (10A) to the rear Support Plate (7A), using the Hex Bolts, Washers, Spring Washers, and Nuts (I). **(See Figure E and Hardware Diagram.)**
8. **NOTE:** Check to make sure the Stand is setting square on the floor. Then, **wrench tighten** all Bolts and Nuts securely.
9. Insert two Lock Pieces (4A) into the two holes located on the underneath of each end of the Front Stand (2A). Insert the remaining two Lock Pieces (4A) into the two holes located on the underneath of each end of the Back Stand (3A). **(See Figure F and Hardware Diagram.)**
10. Attach the four Stand Assemblies (II) to the four Lock Pieces (4A). **(See Figure F and Hardware Diagram.)**



To Assemble The Motor Onto The Stand:

1. Note: For both the Model 32208 Band Saw and the Model 32206 Band Saw, make sure to attach the Motor Pulley (3D, Model 32208 - part #1C, Model 32206) onto the Shaft of the Motor (11A) before proceeding with the following instructions. Also, for the Model 32208 Band Saw, make sure to attach the Motor Pulley (3D) with its largest diameter closest to the Motor. **(See Figure E)**
2. Attach the Motor (11A) to the Motor Plate (10A), using the four Hex Bolts, Washers, Spring Washers, and Nuts (IV). Note: During this step loosely finger tighten the Bolts and Nuts. **(See Figures G and H on page 8, and the Hardware Diagram on page 27.)**

Note: Attach both 8A and 9A underneath the Face Plate (#1A) - see Assembly Diagram A on page 20 for clearer view.

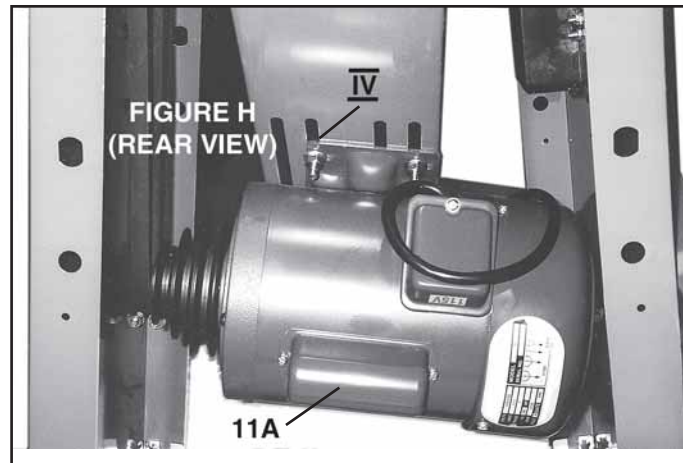
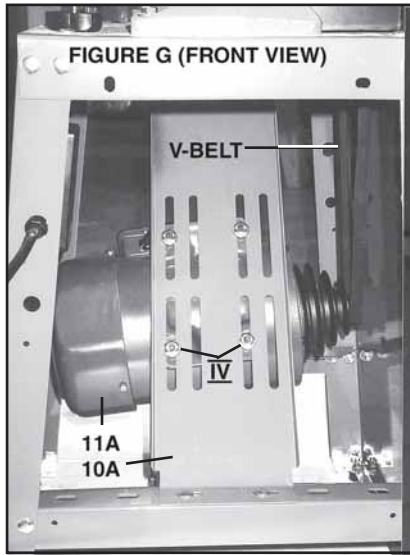
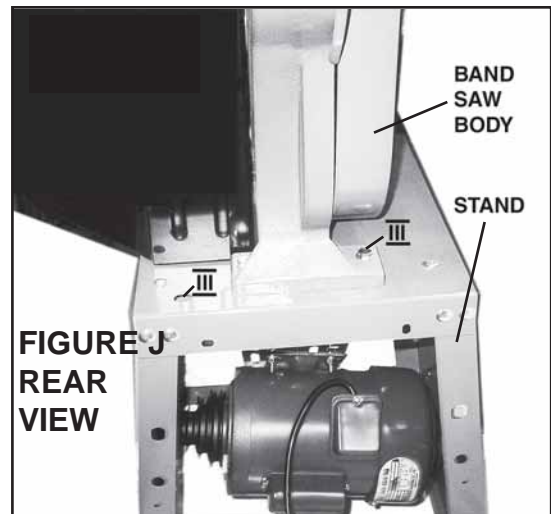
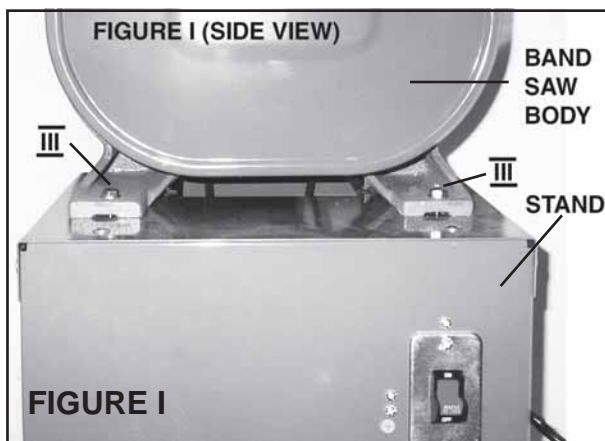

FIGURE H (REAR VIEW)

To Assemble The Bandsaw Body To The Stand:

1. With additional help, set the Bandsaw Body on the Stand. Make sure the Table (36B) faces to the *front* of the Stand.
2. Align the four mounting holes on the Base (2B) of the Bandsaw Body with the holes located on the Face Plate (1A) of the Stand.
3. Attach the Bandsaw Body securely to the Stand, using the four Hex Bolts, Washers, Spring Washers, and Nuts (III). **(See Figures I, J, and Hardware Diagram.)**



To Mount The V-Belt Onto The Belt Pulley And Motor Pulley - Model 32206/ Single Speed:

1. Open the Side Panel Door (38A). **(See Figure K.)**

2. Place the V-Belt (2C) onto the Belt Pulley (23B) and also onto the Motor Pulley (1C). **NOTE:** During this step, you may need to push the Motor (11A) upward along the grooves in the Motor Plate (10A) in order to mount the V-Belt onto the Motor Pulley. **(See Figures G and H.)**
3. To adjust the V-Belt (2C) to its proper tension, pull down on the Motor (11A). While pulling down on the Motor, push in on the V-Belt with your finger until the V-Belt can only be pushed in about 1/2". While holding the Motor in place, wrench tighten the Motor (11A) to the Motor Plate (10A) with the four Hex Bolts, Washers, Spring Washers, and Nuts (IV). **(See Figures G and H.)**
4. **NOTE:** For additional technical information, **see Figure M.**
5. While the Side Panel Door (38A) is still open, attach the Knob (VI) to the Door. Then, close the Side Panel Door securely. **(See Figure K and Hardware Diagram.)**

**To Mount The V-Belt Onto The Belt Pulley
And Motor Pulley - Model 32208/
Four Speed:**

1. Open the Side Panel Door (38A). **(See Figure K.)**
2. **NOTE:** This particular model Bandsaw features four different RPM speeds from which to choose. In order to mount the two V-Belts onto the correct pulleys to achieve the desired RPM **see Figure M.**
3. Place the V-Belt (5D) onto the Belt Pulley (23B) and also onto the Middle Pulley (1D). **(See Figure L.)**
4. Place the other V-Belt (4D) onto the Middle Pulley (1D) and also onto the Motor Pulley (3D). **NOTE:** During this step, you may need to push the Motor (11A) upward along the grooves in the Motor Plate (10A) in order to mount the V-Belt onto the Motor Pulley. **(See Figures G and H.)**
5. To adjust the V-Belt (4D) to its proper tension, pull down on the Motor (11A). While pulling down on the Motor, push in on the V-Belt with your finger until the V-Belt can only be pushed in about 1/2". While holding the Motor in place, wrench tighten the Motor (11A) to the Motor Plate (10A) with the four Hex Bolts, Washers, Spring Washers, and Nuts (IV). **(See Figures G and H.)**

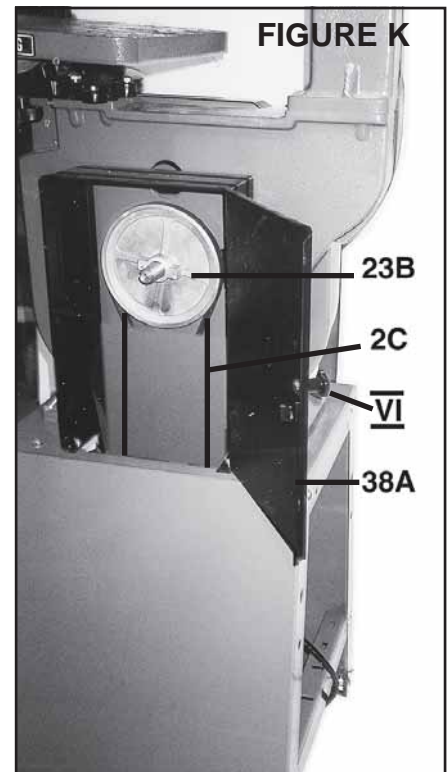

6. While the Side Panel Door (38A) is still open, attach the Knob (VI) to the Door. Then, close the Side Panel Door securely. **(See Figure K and Hardware Diagram.)**

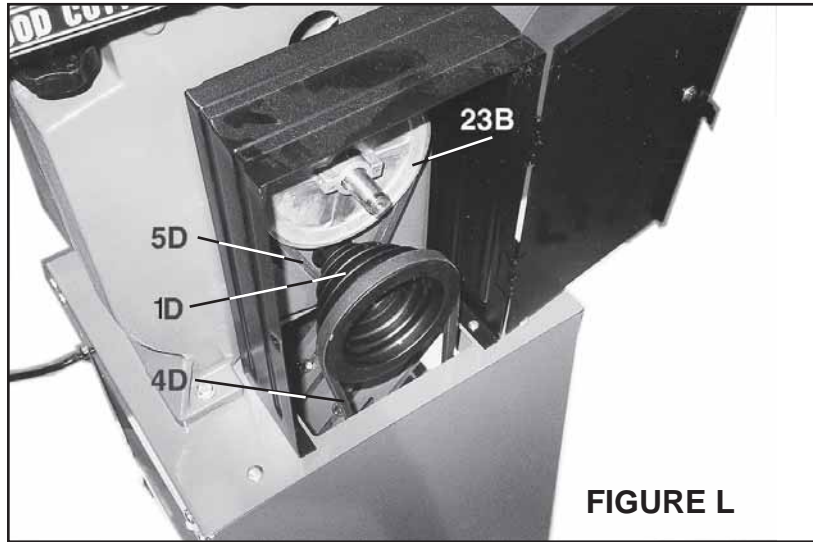

FIGURE L

FIGURE M

SPEED		SINGLE	FOUR
SPINDLE PULLEY (A)			
MIDDLE PULLEY (B)			1 2 3 4 5
MOTOR PULLEY (C)			4 3 1 2 1
SPINDLE SPEED R.P.M. (60 Hz)		3000	600
			1140
			1670
			2670
SAW BLADE m/min • ft/min		908 • 2760	190.5 • 625.1
			323.5 • 1061.3
			513.1 • 1683.2
			786 • 2578.4
BELT		A-C (A55)	A-B1 B5-C1 (A22, A42)
			A-B1 B4-C2 (A22, A42)
			A-B1 B3-C3 (A22, A42)
			A-B1 B2-C4 (A22, A42)

To Install The Side Panels To The Stand:

1. With a Philips screwdriver, start the Tapping Screws (40A) into the Relief Stops (39A). **(See Figure N.)**
2. Attach the Relief Stops (39A) to the Side Panel (38A) by partially screwing the Tapping Screws (40A) into the mounting holes on the Side Panel. The Stops are highlighted in **Figure O - step 1**.
3. Position the Relief Stops (39A) so that the Stops (39A) point towards the center of the Side Panel (38).
4. While holding the Side Panel (38A) by the two finger holes, place it inside the side of the Stand as shown in **Figure O - step 2**. Rotate the Relief Stops (39A) out and screw in the Tapping Screws (40A) to secure the Side Panel in place. Repeat the process for the other Side Panel (38A).

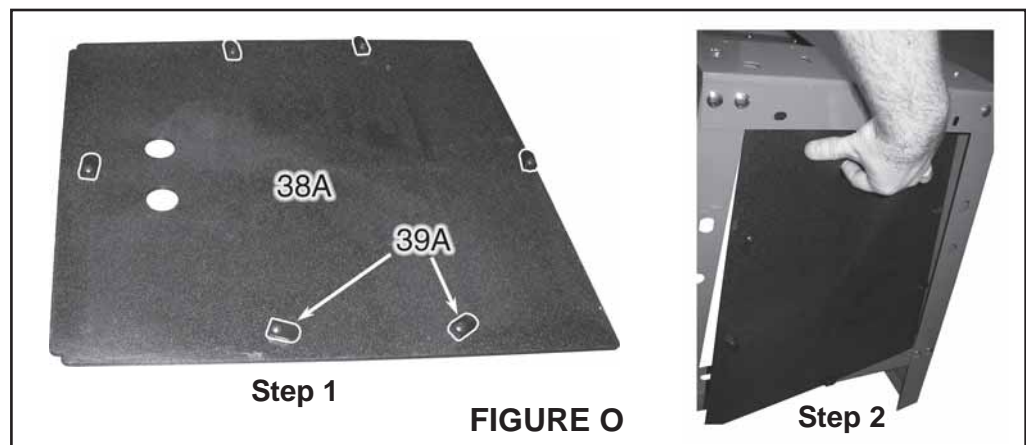

To Install The Saw Blade:

Wear Gloves; be careful of sharp blade teeth when handling.

1. Remove the four Knobs (15B) from the Upper and Lower Wheel Guards (14B, 21B). **(See Figure P.)**
2. Remove and set aside the Upper and Lower Wheel Guards (14B, 21B).
3. Remove the Table Insert (37B) and Table Pin (38B). **(See Figure Q.)**

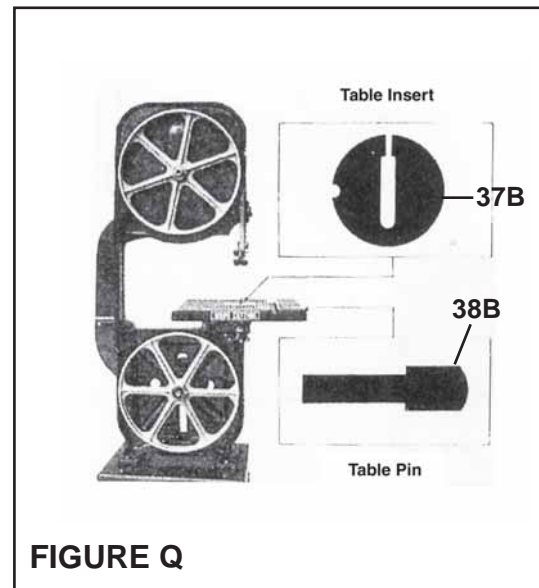
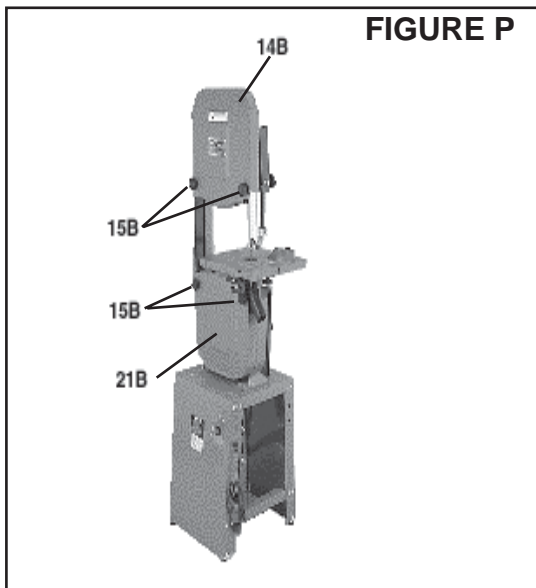

REV
07/04

4. Turn the Blade Adjusting Screw (5B) *counterclockwise* about 5-10 full turns. **(See Figure R.)**
5. With both hands, hold the Saw Blade with its ***teeth pointing downward*** and away from your body. Then, insert the Saw Blade through the horizontal slot in the Table (36B). **(See Figure S.)**
6. Place the Saw Blade on the Upper and Lower Wheels (16B, 19B). **(See Figures T and U.)**

FIGURE R

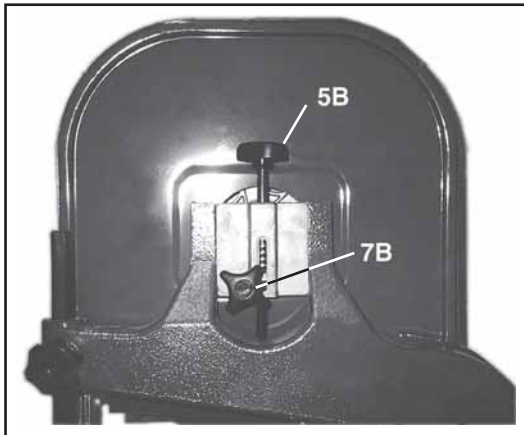
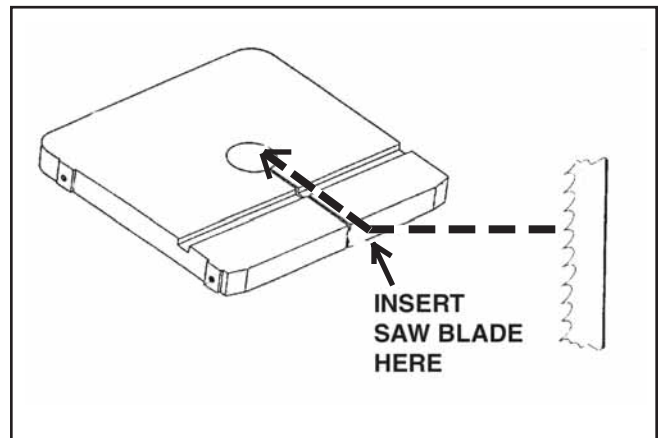

FIGURE S



7. Position the Saw Blade in the Upper and Lower Blade Guides (29B, 32B). **(See Figures T and V.)**
8. Replace the Table Insert (37B) and Table Pin (38B). **(See Figure Q.)**
9. Replace the Upper and Lower Wheel Guards (14B, 21B), and secure the Guards to the Bandsaw with the four Knobs (15B). **(See Figure P.)**

FIGURE T

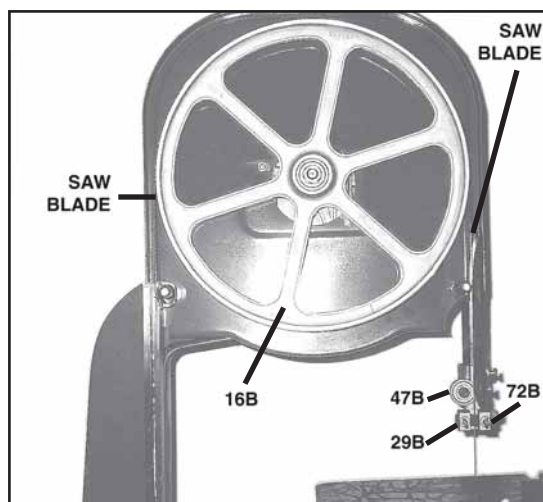
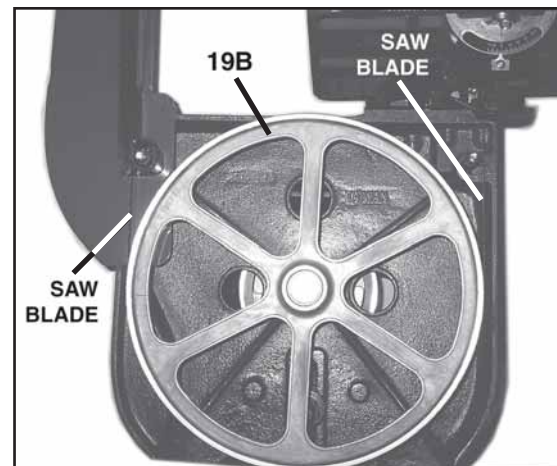

FIGURE U



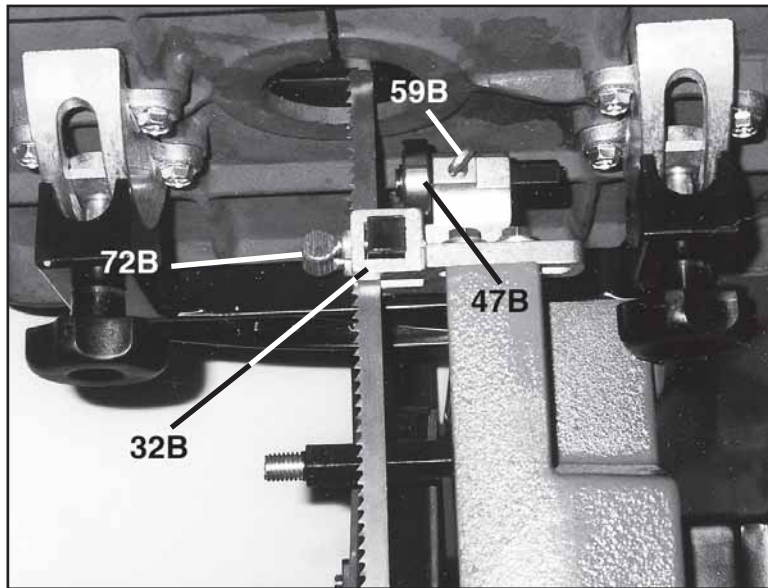

FIGURE V

To Adjust The Saw Blade Tension:

1. To tighten the tension on the Saw Blade, turn the Blade Adjusting Screw (5B) clockwise. (See Figure R.)
2. To loosen the tension on the Saw Blade, turn the Blade Adjusting Screw (5B) counterclockwise.
3. The correct Saw Blade tension is achieved when, with your finger, you can push the Saw Blade in about 1" (25.4mm) at the midway point between the Upper and Lower Wheels (16B, 19B). (See Figures T and U.)
4. **NOTE:** Too much tension is a common cause of Saw Blade breakage and other unsatisfactory performance. Relax the tension when the Bandsaw is not in use.

To Adjust The Tracking Of The Saw Blade:

1. After tension has been applied to the Saw Blade, slowly turn the Upper and Lower Wheels (16B, 19B) forward by hand and watch the Saw Blade to see that it travels in the *center* of the Upper Wheel.
2. If the Saw Blade begins to creep toward the front edge of the Upper Wheel (16B), turn the Knob Bolt (7B) counterclockwise. This will tilt the top of the Upper Wheel toward the back of the machine, drawing the Saw Blade toward the center of the Upper Wheel.
3. If the Saw Blade begins to creep toward the back edge of the Upper Wheel (16B), turn the Knob Bolt (7B) clockwise. This will tilt the top of the Upper Wheel toward the front of the machine, drawing the Saw Blade toward the center of the Upper Wheel.

4. **NOTE:** Adjust the Knob Bolt (7B) only a fraction at a time. Never attempt to adjust the tracking of the Saw Blade while the Bandsaw is running.

To Adjust The Upper Blade Guides And Support Bearings:

1. The Upper Blade Guides (29B) and Upper Blade Guide Support Bearing (47B) should be adjusted only after the Saw Blade tension and tracking is properly adjusted. **(See Figure T.)**
2. The Upper Blade Guides (29B) are held in place by the two Thumb Bolts (72B).
3. Loosen the two Thumb Bolts (72B) to move the Upper Blade Guides (29B) as close as possible to the side of the Saw Blade, being careful not to pinch the Saw Blade. Then, securely tighten the Thumb Bolts.
4. The Upper Blade Guide Support Bearing (47B) prevents the Saw Blade from being pushed too far to the back. The Upper Blade Guide Support Bearing should be set 1/64" (0.4mm) behind the Saw Blade by loosening the Hex Head Bolt (61B) to move the Upper Blade Guide Support Bearing in or out.
5. The Upper Blade Guide Support Bearing (47B) should also be adjusted so the back edge of the Saw Blade overlaps the outside diameter of the Blade Guide Support Bearing by about 1/16".

To Adjust The Lower Blade Guide And Support Bearing:

1. The Lower Blade Guides (32B) and Lower Blade Guide Support Bearing (47B) should be adjusted at the same time as the Upper Blade Guides and Upper Blade Guide Support Bearing. **(See Figure V.)**
2. Loosen the two Thumb Bolts (72B) to move the Lower Blade Guides (32B) as close as possible to the side of the Saw Blade, being careful not to pinch the Saw Blade. Then, securely tighten the Thumb Bolts.
3. The Lower Blade Guide Support Bearing (47B) should be adjusted so it is about 1/64" (0.4mm) behind the back of the Saw Blade by turning the Bolt (59B).

To Adjust The Upper Blade Guide Assembly:

1. The Upper Blade Guide Assembly should always be set as close as possible to the top surface of the material being cut. To do so, loosen the Knob Bolt (25B) and raise or lower the Upper Blade Guide Assembly to the desired position. Then, securely tighten the Knob Bolt. **(See Figure W.)**

To Attach The Guide Post Guard:

1. Remove the Knob Bolt (25B) which locks the Guide Post (24B) in position. **(See Figure X.)**
2. Align the two holes in the Upper Guide Cover (83B) with the Knob Bolt hole (25B) and the hole located at the bottom/front of the Upper Frame Arm (1B).
3. Attach the Upper Guide Cover (83B) to the Upper Frame Arm (1B), using the Hex Bolt (86B), the Washer (85B), and the Lock Washer (87B).
4. Replace the Knob Bolt (25B). Adjust the Guide Post (24B) to the desired height, and securely tighten the Knob Bolt.

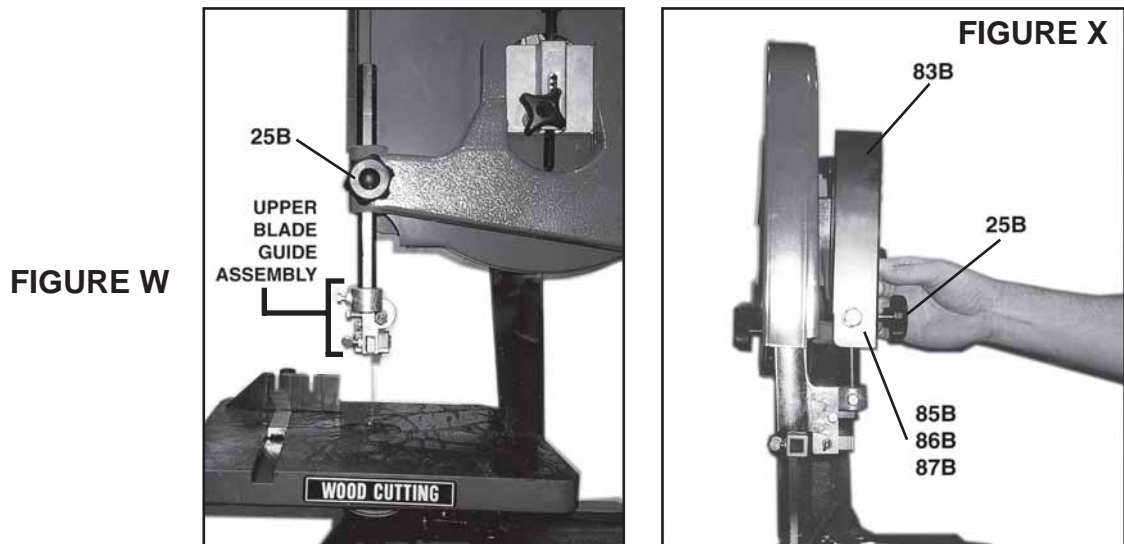

To Adjust The Angle Of The Table:

1. The Bandsaw is equipped with a Table (36B) capable of being adjusted up to 15° to the left and up to 45° to the right. **(See Figures Y* and Z*.)**
2. To adjust the Table (36B) to ensure the Table is 90° to the Saw Blade, loosen the two Knobs (15B) which are located on the underneath of the Table.
3. Tilt the Table (36B) to the left or right until the Needle points to “0” on the Scale (40B). Then, securely tighten the two Knobs (15B).

(*Figures Y and Z see page 16.)

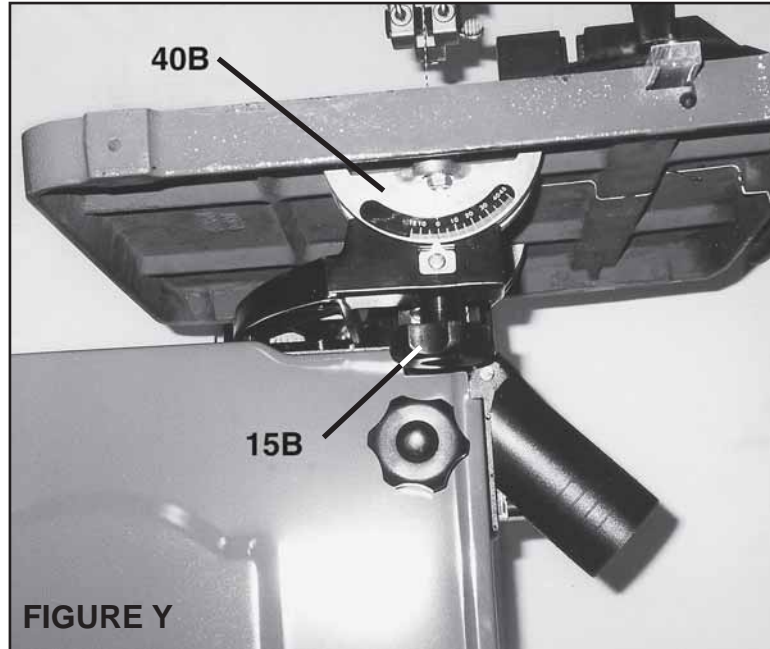

FIGURE Y



FIGURE Z

To Attach The Dust Chute:

1. Remove the two Knobs (15B) located on the Lower Wheel Guard (21B). Then, remove the Lower Wheel Guard. **(See Figure P.)**
2. Attach the Dust Chute (22B) to the top/right corner of the Lower Wheel Guard (21B), using the two Hex Head Bolts (70B). **(See Figures AA* and BB*.)**
3. Replace the Lower Wheel Guard (21B) and the two Knobs (15B).

(*Figures AA and BB see page 17.)

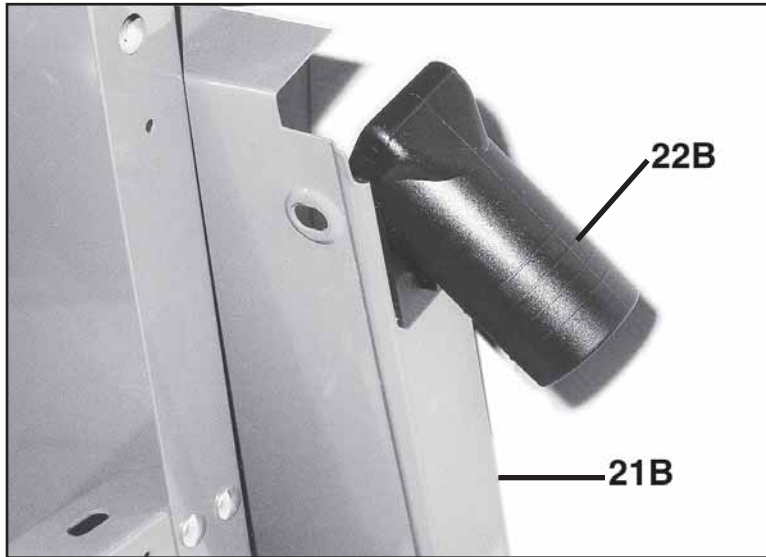
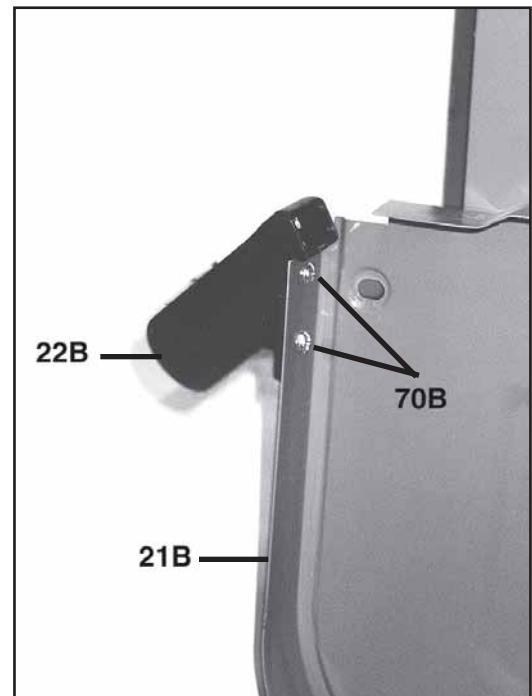

FIGURE AA

FIGURE BB



To Operate The Bandsaw:

1. Before starting the Bandsaw make sure all adjustments are properly made and all of the guards are in place.
2. **Before turning on the power**, turn the Belt Pulley (23B) by hand to make sure there is no binding of moving parts.
3. Keep the Upper Blade Guide Assembly (**See Figure W**) down as close to the material being cut as possible.
4. When turning on the Bandsaw, allow the machine to reach its full speed before cutting the material.
5. Do not force the material into the Saw Blade. Light contact with the Saw Blade will permit easier following of the line and prevent undue friction, heating and work-hardening of the Saw Blade at its back edge.
6. Keep the Saw Blade sharp for easier forward pressure when cutting.
7. Move the material slowly and steadily against the Saw Blade.
8. Avoid twisting the Saw Blade when attempting to turn sharp corners. Remember to saw around corners.

9. When cutting curves, turn the material carefully so that the Saw Blade can follow the line without being twisted.
10. If a curve is so abrupt that it is necessary to repeatedly back up and cut a new kerf, a more narrow Saw Blade should be used.

Troubleshooting Guide:

1. **Motor will not start:**
 - A. Band Saw is not plugged in.
 - B. Household circuit has blown fuse or open circuit breaker.
 - C. Power cord is damaged. Replace.
 - D. Switch is not in "on" position.
 - E. Motor requires service.
2. **Band Saw blade does not move although motor is running:**
 - A. Blade tension knob is not tight. Turn motor off. Tighten knob. Restart band saw.
 - B. Blade has slipped off pulley wheel. Open cover housing and check.
 - C. Blade is broken. Replace blade.
3. **Blade will not cut or cuts slowly:**
 - A. Teeth have been dulled by contact with hardened steel or long usage. Replace blade.
 - B. Use higher speed setting.
 - C. Blade mounted backwards.
4. **Sawdust fills up inside of band saw:**
 - A. This is normal - clean out periodically.
 - B. Remove cover housing. Use vacuum cleaner to remove sawdust.
5. **Sawdust in motor housing:**
 - A. Use vacuum cleaner nozzle on air intake and exhaust grills.
 - B. Keep workplace cleaner. Clean up excess sawdust frequently.
6. **Unable to get blade to track in driver of wheel:**
 - A. Back bearing not properly adjusted.
 - B. Tension Wheel not properly adjusted.
 - C. Bad blade. Replace blade.

CLEANING, INSPECTION, AND MAINTENANCE

1. **Caution:** Always disconnect this Bandsaw from its electrical power supply source before performing any cleaning, inspection, or maintenance.

2. Do not introduce water into the electric motor through the motor vents.
3. Do not use solvents to wipe off the Bandsaw, as damage may result.
4. With a brush or soft cloth, remove all the sawdust from the Bandsaw.
5. If necessary, wipe with a damp cloth. You may use a mild detergent.
6. Once clean, lubricate all moving parts with a light oil.
7. When storing, keep the Bandsaw covered with a cloth cover.
8. Before each use, inspect the general condition of the Bandsaw. Inspect switch, power plug and cord assembly, and extension cord (if used) for damage. Check for loose screws, misalignment, binding of moving parts, broken, cracked, or improper mounting of saw blade, broken parts and any other condition that may affect its safe operation. If abnormal noise or vibration occurs, turn off the Bandsaw immediately and have the problem corrected before further use. Do not use damaged equipment.

PLEASE READ THE FOLLOWING CAREFULLY

THE MANUFACTURER AND/OR DISTRIBUTOR HAS PROVIDED THE PARTS DIAGRAM IN THIS MANUAL AS A REFERENCE TOOL ONLY. NEITHER THE MANUFACTURER NOR DISTRIBUTOR MAKES ANY REPRESENTATION OR WARRANTY OF ANY KIND TO THE BUYER THAT HE OR SHE IS QUALIFIED TO MAKE ANY REPAIRS TO THE PRODUCT OR THAT HE OR SHE IS QUALIFIED TO REPLACE ANY PARTS OF THE PRODUCT. IN FACT, THE MANUFACTURER AND/OR DISTRIBUTOR EXPRESSLY STATES THAT ALL REPAIRS AND PARTS REPLACEMENTS SHOULD BE UNDERTAKEN BY CERTIFIED AND LICENSED TECHNICIANS AND NOT BY THE BUYER. THE BUYER ASSUMES ALL RISK AND LIABILITY ARISING OUT OF HIS OR HER REPAIRS TO THE ORIGINAL PRODUCT OR REPLACEMENT PARTS THERETO, OR ARISING OUT OF HIS OR HER INSTALLATION OF REPLACEMENT PARTS THERETO.

NOTE: Some parts are listed and shown on the following pages for illustration purposes only, and are not available individually as replacement parts.

ASSEMBLY DIAGRAM A

NOTE: When ordering parts listed on Assembly Diagram A, include the suffix "A" behind the part number.

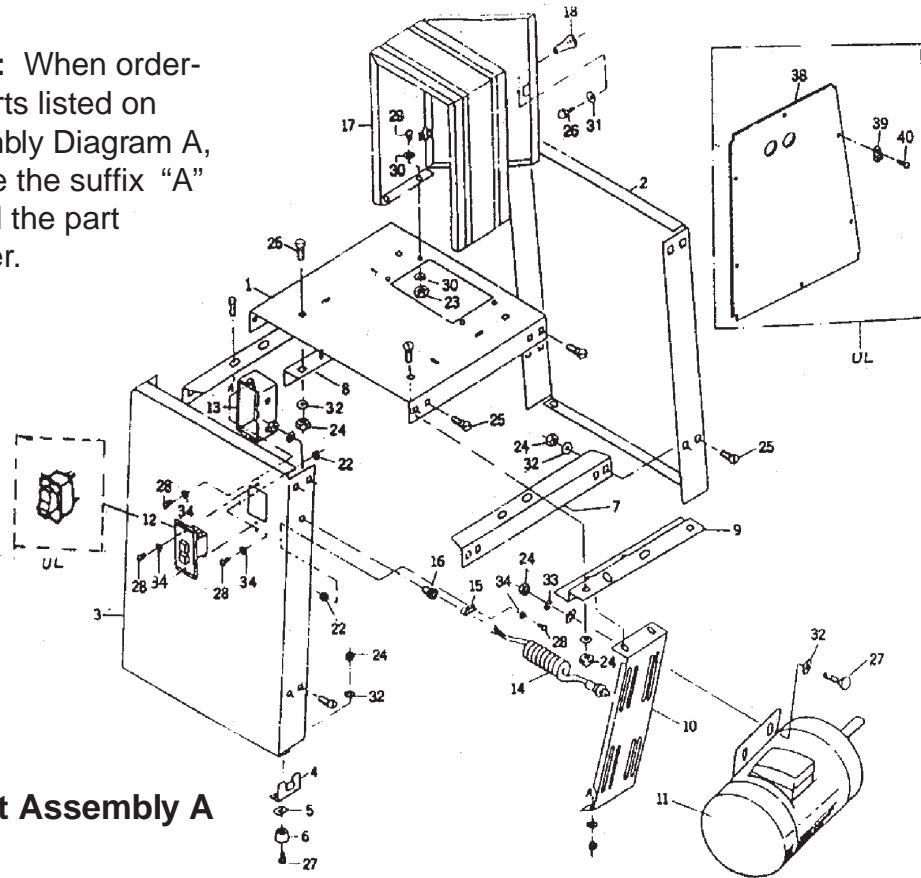

Parts List Assembly A STAND

Key No.	Part No.	Description	Size	Qty	Key No.	Part No.	Description	Size	Qty
1	113101	Face Plate		1	22	991213	Nut	3/16"	2
2	113102	Stand (Front)		1	23	991110	Nut	M5	4*
3	113103	Stand (Back)		1	24	991112	Nut	M8	32*
4	998529	Lock Piece		4	25	991516	Carriage Bolt	M8X16	24*
5	991705	Washer (Special)		4	26	990112	Hex Head Bolt	M6X12	1*
6	998632	Rubber Pad		4	27	990133	Hex Head Bolt	M8X25	8*
7	600104	Support Plate		2	28	990855	Pan Head Bolt	3/16"X1/2"	6
8	600108	Stiffening Plate		1	29	990825	Pan Head Bolt	M5X1/2	4*
9	600109	Motor Plate Bracket		1	30	991710	Flat Washer	M5XØ10	8*
10	600107	Motor Plate		1	31	991731	Flat Washer	M6XØ16	1*
11		Motor	\$	1	32	991743	Flat Washer	M8XØ18	36*
12	994532	Switch (UL)	\$	1	33	991931	Lock Washer	M8	4*
13	523028(U)	Switch Cover	\$	1	34	991881	Star Washer	M5	6*
14		Power Cord	\$	1	38	379112	Side Panel (UL)		2
15	998625	Wire Clip		1	39	998640	Relief Stop (UL)		12
16		Screw		1	40	990811	Tapping Screw (UL)	M3.5X12	12
17	100111	Pulley Case		1					
18	998634	Knob		1					

"*" - Indicates that the part is included in Hardware Package Bag.

"\$" - Indicates that the part is an Alternative Part.

"#" - Indicates that the part is part of the A Assembly Set.

ASSEMBLY DIAGRAM B

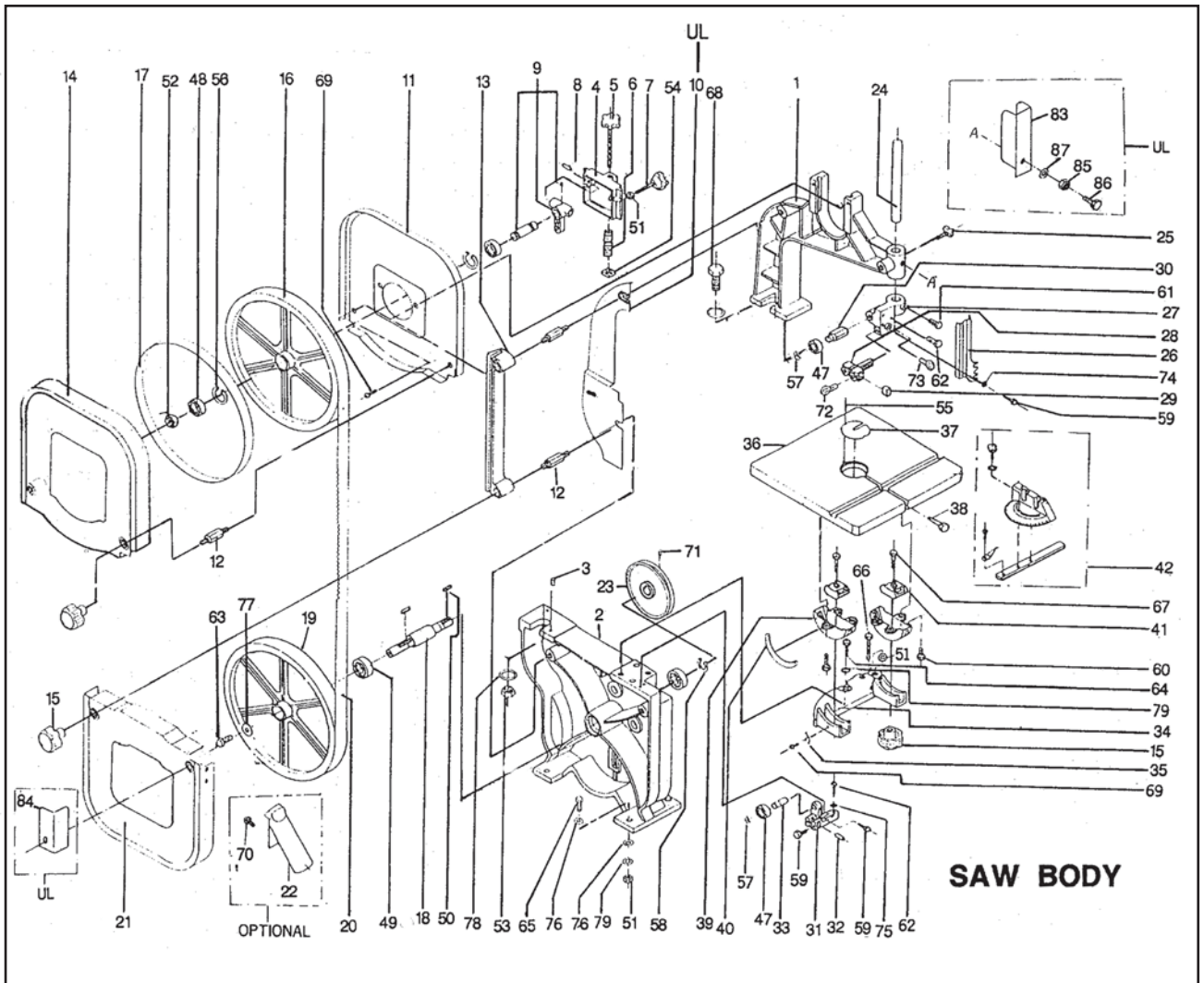

NOTE: When ordering parts listed on Assembly Diagram B, include the suffix "B" behind the part number.

PARTS LIST ASSEMBLY B - Saw Body

Key No.	Part No.	Description	Size	Q'ty
1	110001	Upper Frame Arm		1
2	110034	Base		1
3	150031	Pin		4
4	100016	Upper Wheel Sliding Bracket		1
5	100014	Blade Adjusting Screw		1
6	100015	Coil Spring		1
7	990633	Knob-Bolt	M8 × 45	1
8	100021	Steel Pin		2
9	A100019	Upper Wheel Shaft Hinge(Assem) #		1
10	199052	Side cover (UL)		1
11	100028	Upper Wheel Guard(Inner)		1
12	100027	Stud		4
13	110070	Blade Guard(L)		1
14	100029	Upper Wheel Guard(Outer)		1
15	100030	Knob	M10	6
16	198240	Upper Wheel		1
17	100025	Wheel Tire		2
18	110065	Lower Wheel Shaft		1
19	198670	Lower Wheel		1
20	100036	Saw Blade 6TPI 92.5" × 3/8" × 0.5mm		1
21	100069	Lower Wheel Guard		1
22	142055	Dust Chute (OPTIONAL) \$		1
23	100063	Belt Pulley		1
24	110004	Guide Post		1
25	990644	Knob-Bolt	M10 × 25	1
26	100062	Blade Guard(R)		1
27	110005	Guide Supportor Bracket		1
28	100006	Blade Guide Supportor		1
29	100011	Blade Guide		2
30	100007	Upper Spacing Sleeve		1
31	110055	Lower Guide Supportor		1
32	100012	Blade Guide		2
33	110058	Spacing Sleeve (Lower)		1
34	110045	Trunnion Support Bracket		1
35	110049	Pointer		1
36	198390	Table \$		1
37	199037P	Table Insert \$		1
38	100038	Table Pin		1
39	100042	Trunnion		1
40	100051	Scale		1
41	100041	Trunnion Clamp Shoe		2
42	AMG-110	Miter Gauge(Assem.) #		1
43				
44				

“*”-Indicates that the part is included in Hardware Package Bag.

“\$”-Indicates that the part is an Alternative Part.

“#”-Indicates that the part is part of the A Assembly Set.

PARTS LIST ASSEMBLY B - Saw Body (continued)

Key No.	Part No.	Description	Size	Q'ty
45				
46				
47	994110	Bearing	6200ZZ	2
48	994011	Bearing	6203Z	2
49	994012	Bearing	6204Z	2
50	992009	Key	5×5×20	2
51	991112	Nut	M8	6
52	991115	Nut	M12×1.25	1
53	991170	Nut	M16	1
54	150090	Square Nut	M10	1
55	992311	Spring Pin	φ 3×8	1
56	992522	Retaining Ring	R35	2
57	992540	Stop Ring	S10	3
58	992547	Stop Ring	S20	1
59	990111	Hex Head Bolt	M6×10	5
60	990932	Hex Head Bolt (Lock)	M6×12	6
61	990113	Hex Head Bolt	M6×16	1
62	990115	Hex Head Bolt	M6×20	3
63	990293	Hex Head Bolt	M8×20 (L, H)	1
64	990134	Hex Head Bolt	M8×30	2 *
65	990136	Hex Head Bolt	M8×40	4 *
66	990141	Hex Head Bolt	M8×80	1 *
67	990154	Hex Head Bolt	M10×50	2
68	990180	Hex Head Bolt	M16×55	1
69	990905	Pan Head Bolt (Lock)	M5×6	3
70	990908	Pan Head Bolt (Lock)	M6×8	2
71	990721	Set Screw	M6×10	1
72	150014	Thumb Bolt	M6×12	2
73	150013	Thumb Bolt	M6×16	1
74	991712	Flat Washer	M6× φ 13	2
75	991731	Flat Washer	M6× φ 16	2 *
76	991743	Flat Washer	M8× φ 18	8 *
77	991741	Flat Washer	M8× φ 30	1
78	991851	Flat Washer	M16× φ 40	2
79	991931	Lock Washer	M8	6 *
80				
81				
82				
83	113075	Upper Guide Cover (UL)		1
84	113080	Lower Guide Cover (UL)		1
85	991113	Nut (UL)	M10	1
86	990146	Hex. Head Bolt (UL)	M10×20	1
87	991751	Flat Washer (UL)	M10× φ 20	1

“*”-Indicates that the part is included in Hardware Package Bag.

“\$”-Indicates that the part is an Alternative Part.

“#”-Indicates that the part is part of the A Assembly Set.

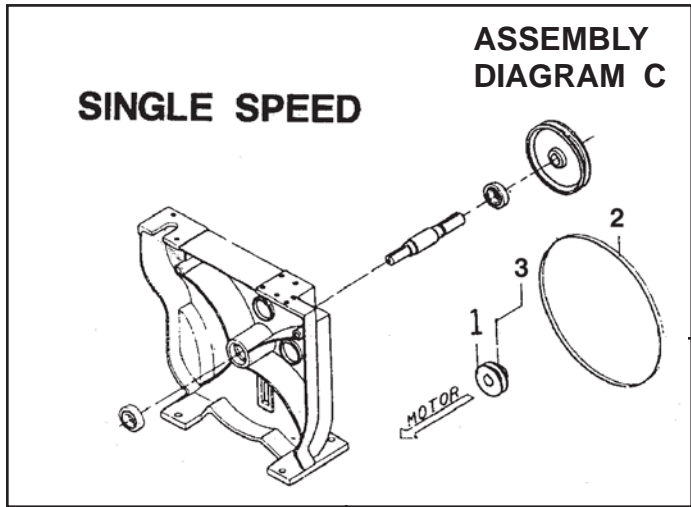

NOTE:
When ordering parts listed on Assembly Diagram C, include the suffix "C" behind the part number.

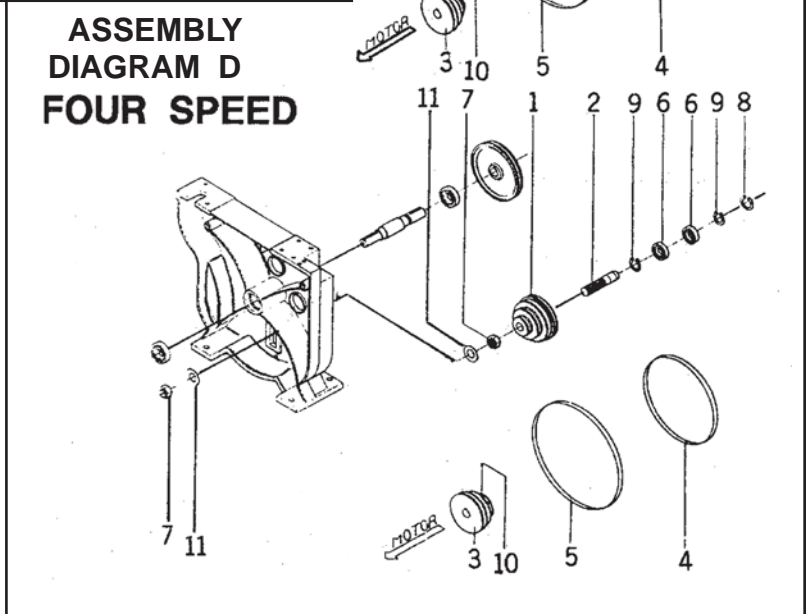

NOTE:
When ordering parts listed on Assembly Diagram D, include the suffix "D" behind the part number.

Parts List Assembly C

KeyNo.	Part No.	Description	Size	Q'ty
--------	----------	-------------	------	------

SINGLE SPEED

1	600013	Motor Pulley		1
2	993021	V - Belt	A55	1
3	990721	Set Screw	M6×10	1

Parts List Assembly D

KeyNo.	Part No.	Description	Size	Q'ty
--------	----------	-------------	------	------

FOUR SPEED

1	140409	Middle Pulley		1
2	120203	Middle Pulley Shaft		1
3	140410	Motor Pulley		1
4	993011	V - Belt	A22	1
5	993017	V - Belt	A42	1
6	994011	Bearing	6202Z	2
7	991411	Nut	M16	2
8	992522	Retaining Ring	R35	1
9	992545	Stop Ring	S15	2
10	990721	Set Screw	M6×10	1
11	991851	Flat Washer	M16×φ40	2

ASSEMBLY DIAGRAM E

NOTE:

When ordering parts listed on Assembly Diagram E, include the suffix "E" behind the part number.

RISER BLOCK KITS (OPTIONAL)

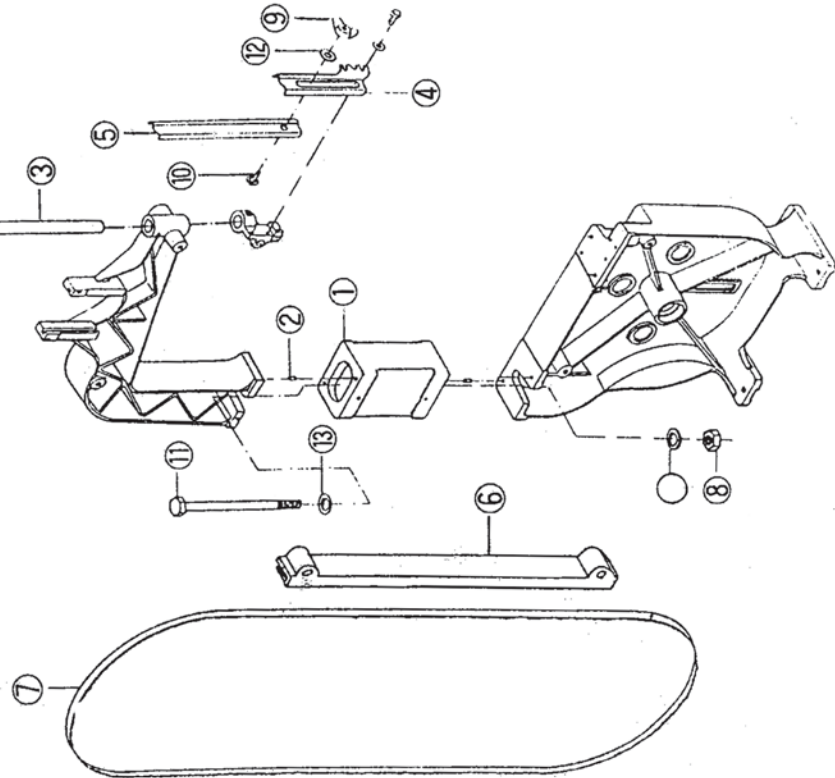

Part No.	Description	Size	Q'ty
1	199189 Riser Block		1
2	150031 Pin		2
3	199198 Guide Post		1
4	199102 Upper Wheel Blade Guard(U)		1
5	199199 Upper Wheel Blade Guard (L)		1
6	173106 Blade Guard		1
7	199196 Saw Blade	6 TPI 3/8" X 105" X 0.5mm	1
8	991415 Nut	5/8" X 11UNC	1
9	998496 Wing Nut	M8	1
10	991516 Carriage Bolt	M8 X 16	1
11	990265 Hex Head Bolt	5/8" X 11UNC X 8-1/2"	1
12	991743 Flat Washer	M8 X φ 18	1
13	991851 Flat Washer	M16 X φ 40	2

RISER BLOCK KIT

ASSEMBLY DIAGRAM F

Part No.	Description	Size	Q'ty
RIP FENCE			
1	199184 Guide Bar		1
2	199185 Fence		1
3	990671 Knob Bolt	M6 X 20	1
4	990323 Hex. Socket Bolt	M6 X 20	2

**RIP FENCE
(OPTIONAL)**

NOTE: When ordering parts listed on Assembly Diagram F, include the suffix "F" behind the part number.

HARDWARE DIAGRAM

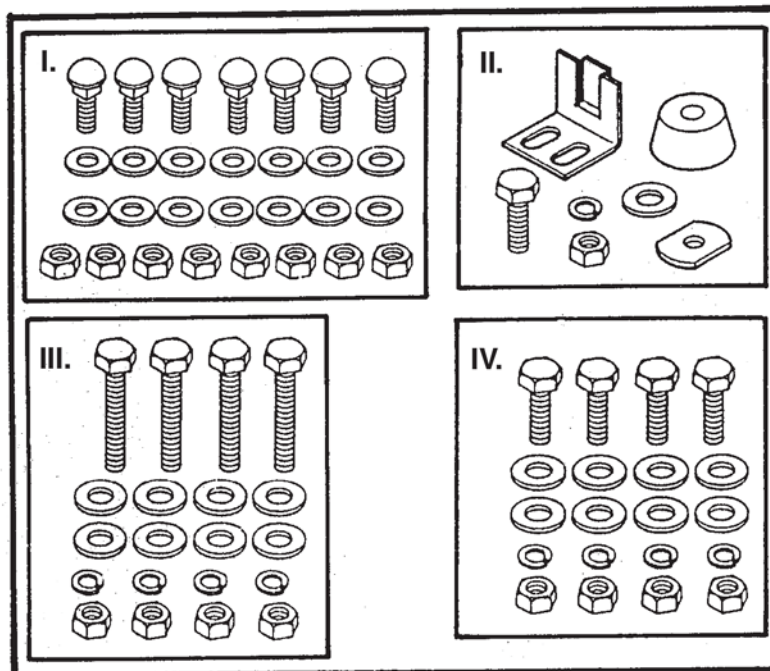

I. Stand Assembly (partial quantity show)

- 24—M8×16 carriage bolts
- 24—M8 washers
- 24—M8 nuts

II. Stand Assembly—Rubber Pads (partial quantity show)

- 4—Lock pieces
- 4—Rubber Pads
- 4—M8×25 Hex Bolts
- 4—M8 Washers
- 4—M8 Spring Washers
- 4—Flat Washers

III. Install Saw Body To Stand

- 4—M8×40 Hex Bolts
- 4—M8 Nuts
- 4—M8 Spring Washer
- 8—M8 Washers

IV. Install Motor To Stand

- 4—M8×25 Hex Bolts
- 4—M8 Nuts
- 4—M8 Spring Washers
- 8—M8 Washers

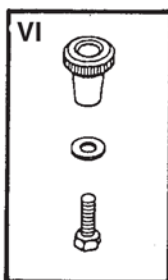
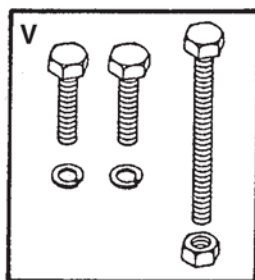

V. Install Trunnion Bracket To Saw Body

- 2—M8×30 Hex Bolts
- 2—M8 Spring Washers
- 1—M8×80 Hex Bolt (Table Stop Bolt)
- 1—M8 Nut (For Table Stop Bolt)

VI. Knob To Pulley Case Door

- 1—M6 Knob
- 1—M6 Washer
- 1—M6×12 Hex Bolt

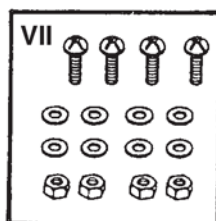

VII. Install Pulley Case To Stand

- 4—M×15 Pan Head Screw
- 8—M55 Washers
- 4—M5 Nuts

WIRING DIAGRAM

